

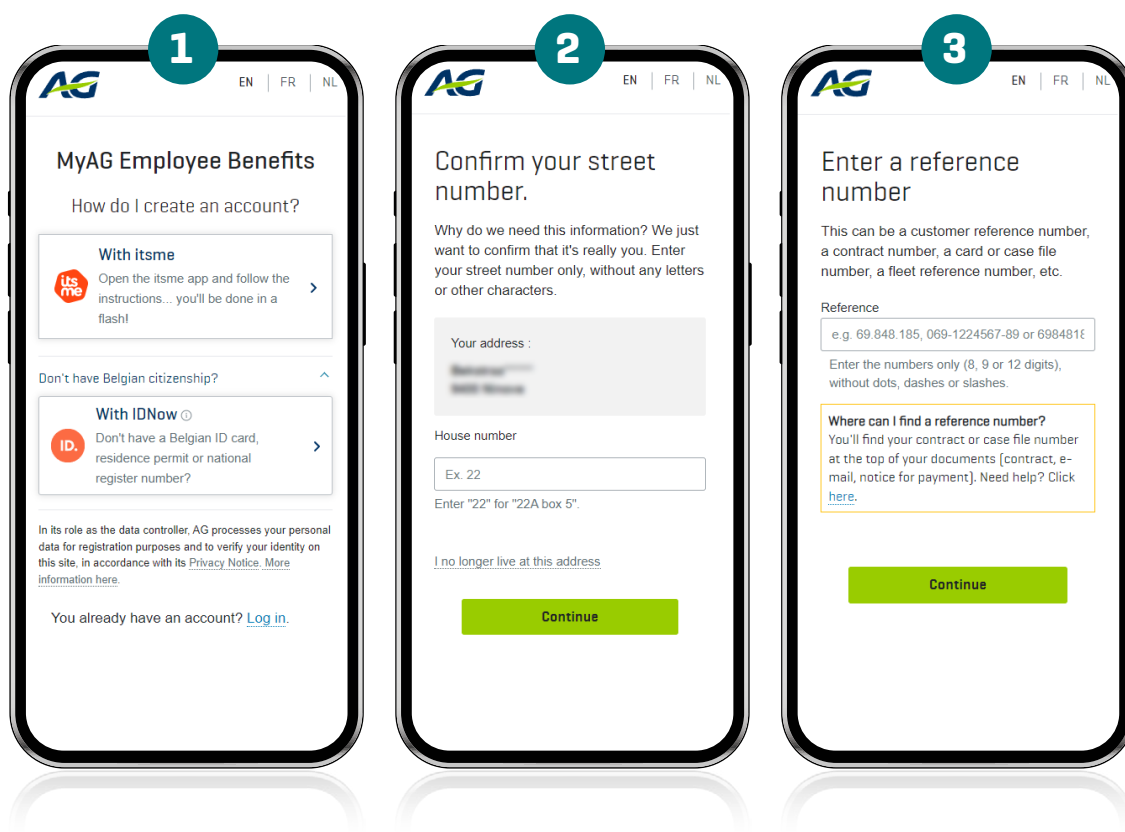

# Never go anywhere without your MyAG Employee Benefits app

## 1) Registration on the MyAG Employee Benefits app (one-time procedure)

- 1 Don't have a MyAG Employee Benefits account yet? Register via Itsme.**  
Choose registration via IDNow if you don't have a Belgian national register number, identity card, or residence permit.
- 2 Check your address** if requested and **enter your house number**.
- 3 Enter your customer reference** if requested. You can find this reference in the letter or email you received when you joined your group insurance.  
This step may be necessary to verify your identity and protect your personal data.  
If this extra check is not sufficient, we'll finally ask you to enter **your email address and phone number** and check the privacy box. This way, we can manually verify your data. We will contact you as soon as possible.



Through the IDNow platform, you can securely verify your identity with a photo of your ID (front and back) and facial recognition. You will then be automatically redirected to AG.



### Need help registering?

Our chatbot AGGIE will help you register and answer all your questions.

More info on how to use the app can be found at:

<https://myageb.aginsurance.be/en/Pages/myageb-app.aspx>.



# Never go anywhere without your **MyAG Employee Benefits app**

## 2) Activating and setting up the app

- 1 Choose a 4-digit PIN code.
- 2 Confirm your PIN code.
- 3 If you wish, you can also set up facial recognition or your fingerprint.
- 4 You're now ready to use the MyAG Employee Benefits app!

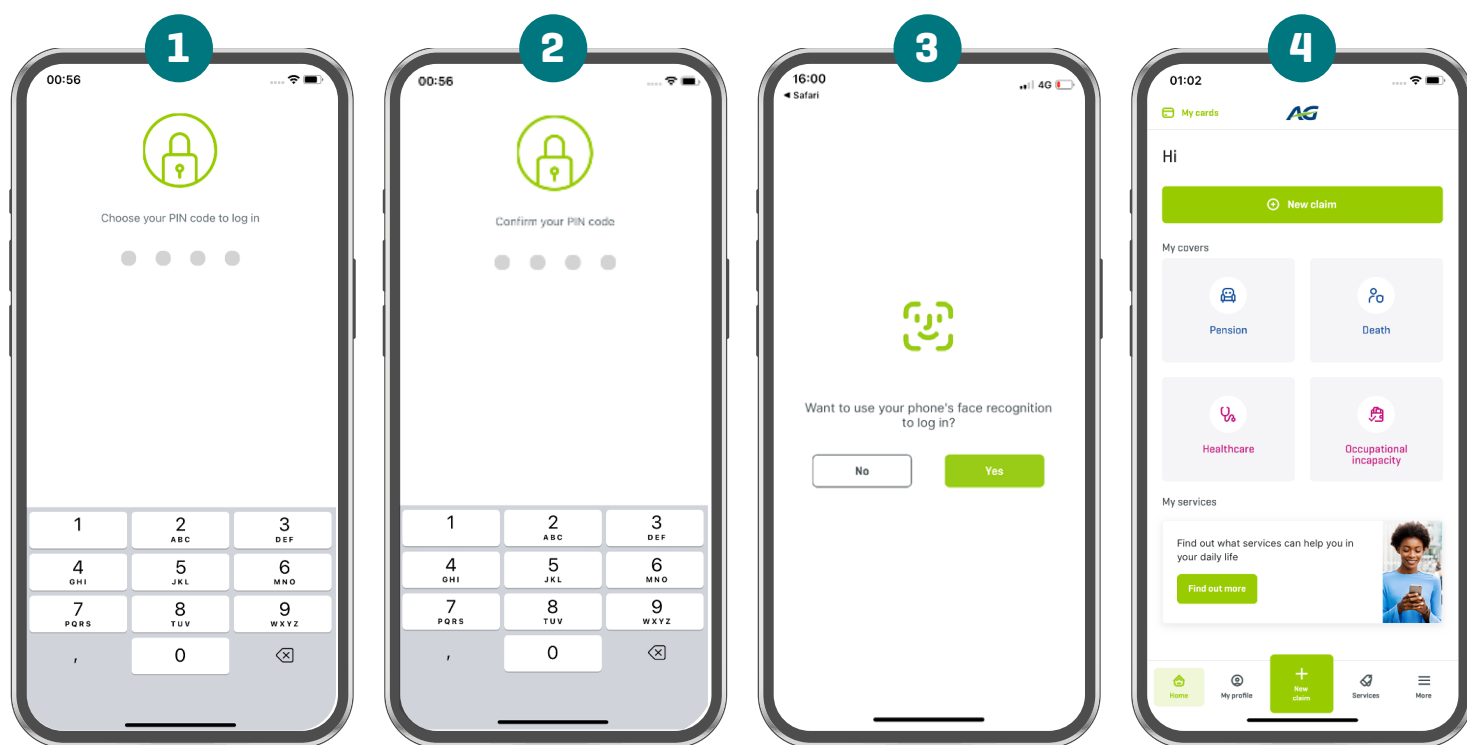

### Need help?

Our chatbot AGGIE will help you and answer all your questions.

More info on how to use the app can be found at:

<https://myageb.aginsurance.be/en/Pages/myageb-app.aspx>.